

INSTALLATION INSTRUCTIONS FOR SECURE FLEX VENT KIT (MODEL NO. SF-12) (CATALOG NO. 98K03) USED WITH DIRTECT VENT GAS FIREPLACES IN HORIZONTAL VENTING APPLICATIONS ONLY

GENERAL INFORMATION

This **Secure Flex** venting kit may be used when horizontally venting a Lennox or Superior direct vent gas fireplace. It contains 12 feet of compressed flex vent.

INSTALLATION INSTRUCTIONS

INSTALLATION SHOULD BE PERFORMED BY A QUALIFIED TECHNICIAN ACCORDING TO THESE INSTRUCTIONS, THE INSTALLATION INSTRUCTIONS FOR THE PARTICULAR APPLIANCE BEING INSTALLED, AND LOCAL CODES.

GENERAL APPLICATIONS

Refer to the fireplace installation instructions for approved horizontal venting configurations. Rigid **Secure Vent** (SV4.5) direct vent components are shown in these configurations; however, these **Secure Flex** vent kits may also be used. All restrictions, clearances and allowances that pertain to the rigid piping apply to the flexible venting also.

Expanding Secure Flex and Secure Flex Joining Restrictions -

Flexible vent pipe is packaged and shipped in its contracted state. When installing flexible vent pipe, its length may be expanded up to twice its contracted size. This 12 ft. section of flexible pipe may be expanded up to 24 ft. The 12 foot section may be cut to any length to suit a particular application; however, **the flex sections must not be joined together to extend a vent run**. After expanding the vent, check that the vent's spring spacers are spaced every 12 inches or less.

Adding Secure Flex to the End of a Secure Vent (Rigid Vent) Run -

Secure Flex may be added to the end of a vent run made up of rigid **Secure Vent** (SV4.5) vent sections. The flex adapter (87L00) must be used when connecting the flexible pipe to the rigid. All the restrictions such as venting length, height, routing, horizontal to vertical ratio requirements or clearance considerations as detailed in the fireplace installation instructions for rigid vent must be adhered to for the flexible vent.

Installation of Secure Flex Adapter -

Secure Flex comes with an adapter (catalog no. 87L00) that can be fitted to the appliance collar or the inclined channel end of the last **Secure Vent** section (SV4.5) in a rigid system. Align the dimpled end of the adapter over the previously installed section or appliance collar, adjusting the radial alignment until the four locking dimples of the adapter are aligned with the inlets of the four incline channels of the last vent section or collar. Push on the adapter until it fully engages, then twist the adapter clockwise running the dimples down and along the incline channels until they seat at the end of the channels. See *Figure 1*.

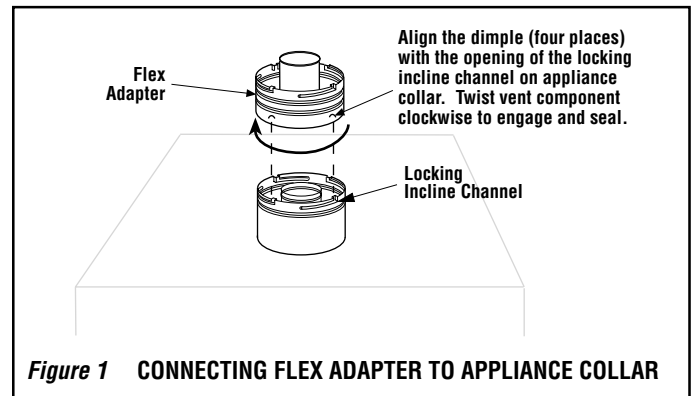

Attaching the Flexible Vent to the Adapter (See parts A and B below and *Figure 2*) -

A. Install the Inner Flex Pipe -

1. Install the small gear clamp loosely around the inner flexible vent pipe, push it back out of the way.
2. Apply a bead of Mill-Pac Black (700°F) high temperature sealant - Catalog No. 10K81) to the inner adapter collar, approximately 1/2 inches from the end.
3. Pull and extend the inner flexible vent pipe.
4. Slide the inner flex pipe over the adapter collar. Overlap the flexible vent pipe with the adapter collar 1 3/4 inches, ensuring that flexible vent pipe is free from damage or tears.
5. Slide the gear clamp down to approximately 3/4 inch from the end of the flexible pipe. Tighten the clamp fully to secure the flexible pipe to the inner adapter collar.
6. Install three screws 120 degrees apart through the flexible vent pipe and into the adapter collar just below the gear clamp to provide additional security to the connection.

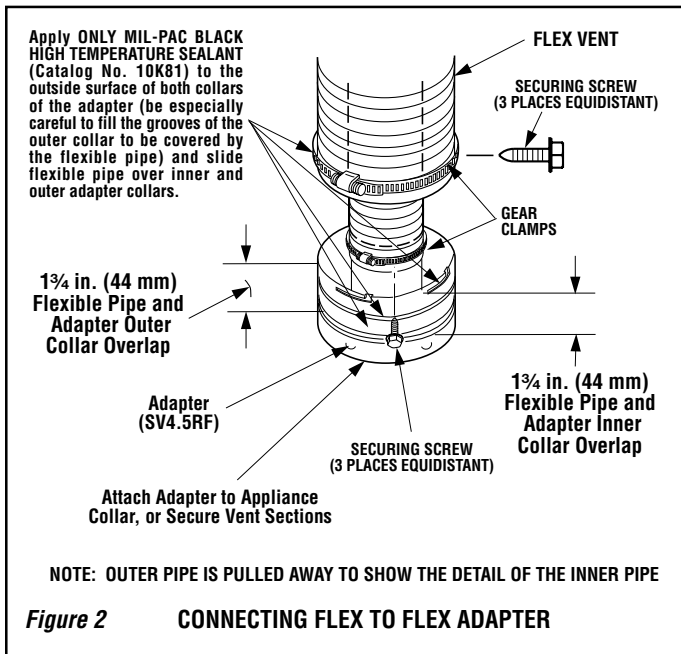

B. Install the Outer Flex Pipe -

1. Install the large gear clamp loosely around the outer flexible vent pipe, push it back out of the way.
2. Apply a bead of Mill-Pac Black (700°F) high temperature sealant - Catalog No. 10K81) to the outer adapter collar; to the grooves of the collar which extend approximately 1 inch from the end and to the flat surface, approximately 1 3/8 inches from the end.
3. Pull and extend the outer flexible vent pipe.
4. Slide the outer flex pipe over the adapter collar. Overlap the flexible vent pipe with the adapter collar 1 3/4 inches, ensuring that the flexible vent pipe is free from damage or tears.

5. Slide the gear clamp down to approximately 3/4 inch from the end of the flexible pipe. Tighten the clamp fully to secure the flexible pipe to the outer adapter collar.
6. Install three screws 120 degrees apart through the flexible vent pipe and into the adapter collar just below the gear clamp to provide additional security to the connection.

Routing Secure Flex Vent -

Ensure that the flex vent is properly routed to provide the required clearance. Do Not allow the flexible vent to bend in a radius tighter than 5" (127 mm). Refer to *Figure 3*. Venting should be sloped upward toward the termination a minimum of 1/4 inch rise per foot (20mm per meter) of horizontal vent run. Support the horizontal vent sections using metal straps spaced at 2 foot (0.61 meter) intervals.

Attaching Secure Flex Vent to Termination -

Connect flex vent only to Secure Flex Vent terminations, not Secure Vent terminations. See *Table 1* for listed Secure Flex vent termination part numbers. Secure the flexible vent to the Secure Flex terminations in the same manner (see *Figure 2*) as it was attached to the adapter.

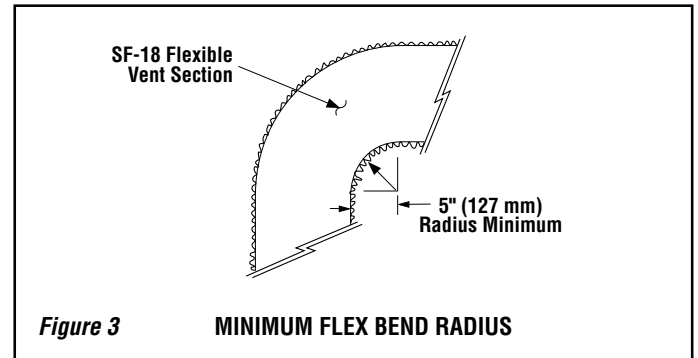

Separately-Ordered Listed Secure Flex Components		
Catalog No.	Model No.	Description
86L94	SF-HTR	Horizontal Round Termination for Flex with Firestop\Spacer (96K80), 4.5" gear clamp (88J01), 7.5" gear clamp (88J00) and Flex adapter (87L00)
86L96	SF-HTS	Horizontal Square Termination for Flex with Firestop\Spacer (96K80), 4.5" gear clamp (88J01), 7.5" gear clamp (88J00) and Flex adapter (87L00)
10K81	SFMP	Mil Pac Black Hi-Temperature Sealant
88J01	SF-GC4	Gear Clamp 4.5" for Flex
83J00	SF-GC7	Gear Clamp 7.5" for Flex
87L00	SF4.5RF	Flex Adapter

Table 1

NOTE: DIAGRAMS & ILLUSTRATIONS NOT TO SCALE.

Security Chimneys International reserves the right to make changes at any time, without notice, in design, materials, specifications, prices and also to discontinue colors, styles and products. Consult your local distributor for fireplace code information.

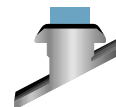

**SECURITY CHIMNEYS
INTERNATIONAL**

1110 West Taft Avenue
Orange, CA 92865