

BRENTWOOD - CLEAN FACE PANEL INSTALLATION

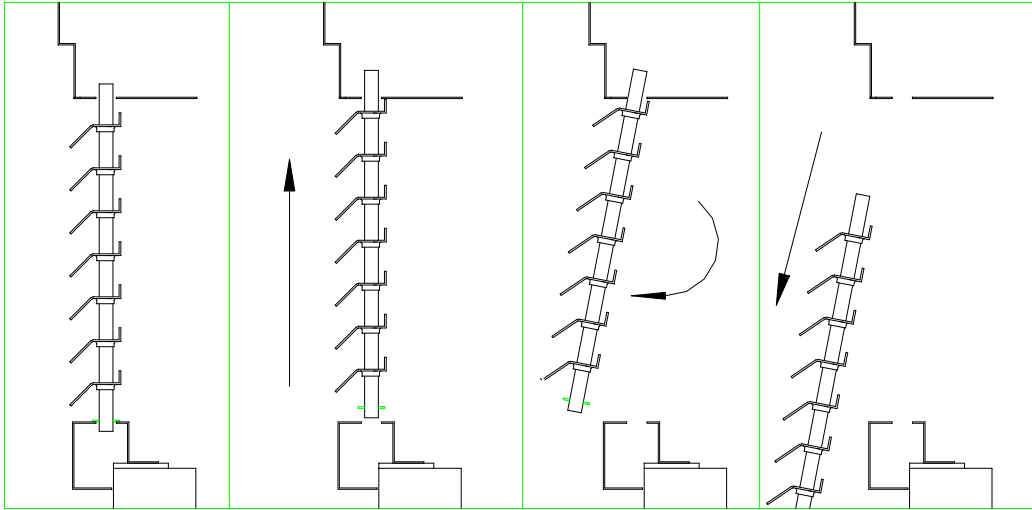

REMOVE THE TOP LOUVERS

- Lift the grill up until the louvers's posts clear the bottom edge of the fireplace opening.
- Rotate the bottom of the grill toward the front of the fireplace and pull it down to remove it.

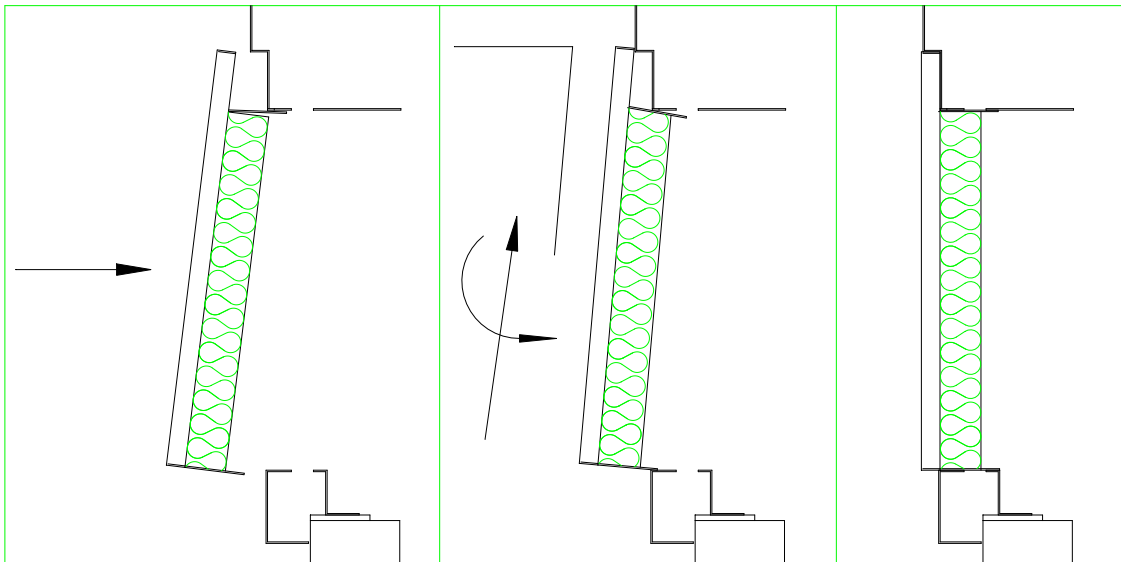

INSTALL CLEAN FACE PANEL

- Tilt the obstruction plate toward the front and lean it against the top edge of the fireplace opening.
- Rotate the bottom of the plate toward the front while pushing it up to clear the bottom edge of the fireplace opening. Push the obstruction plate all the way in, parallel to the facade.